

# Type APM-I Automotive Blade Fuse Miniature – LED Indicating



www.optifuse.com (619) 593-5050

## Specifications:

- Voltage: 32V DC
- Amperage: 2A, 3A, 4A, 5A, 7.5A, 10A, 15A, 20A, 25A, 30A
- Body: Resin
- Terminals: Zinc Alloy
- Designed to meet SAE J2077 and ISO 8820-3 Standards.

Part Number	Amperage	Body Color
APM-I-2A	2A	Grey
APM-I-3A	3A	Violet
APM-I-4A	4A	Pink
APM-I-5A	5A	Tan
APM-I-7.5A	7.5A	Brown
APM-I-10A	10A	Red
APM-I-15A	15A	Blue
APM-I-20A	20A	Yellow
APM-I-25A	25A	Clear
APM-I-30A	30A	Green

Time Characteristics:		
% of Rated Current	Min Hold Time	Max Hold Time
110%	100h	
135%	750ms	1800s
200%	150ms	5s
350%	80ms	250ms

## Mechanical Dimensions: Inches [mm]

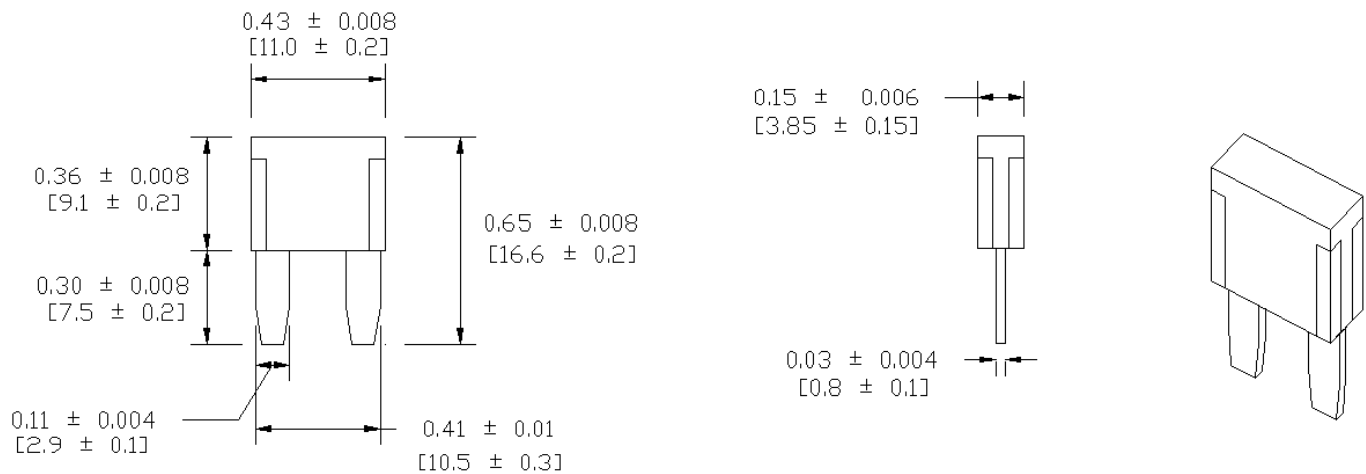

**Type APM-I  
Automotive Blade Fuse  
Miniature – LED Indicating**



www.optifuse.com

(619) 593-5050

**Time Current Curve Graph**

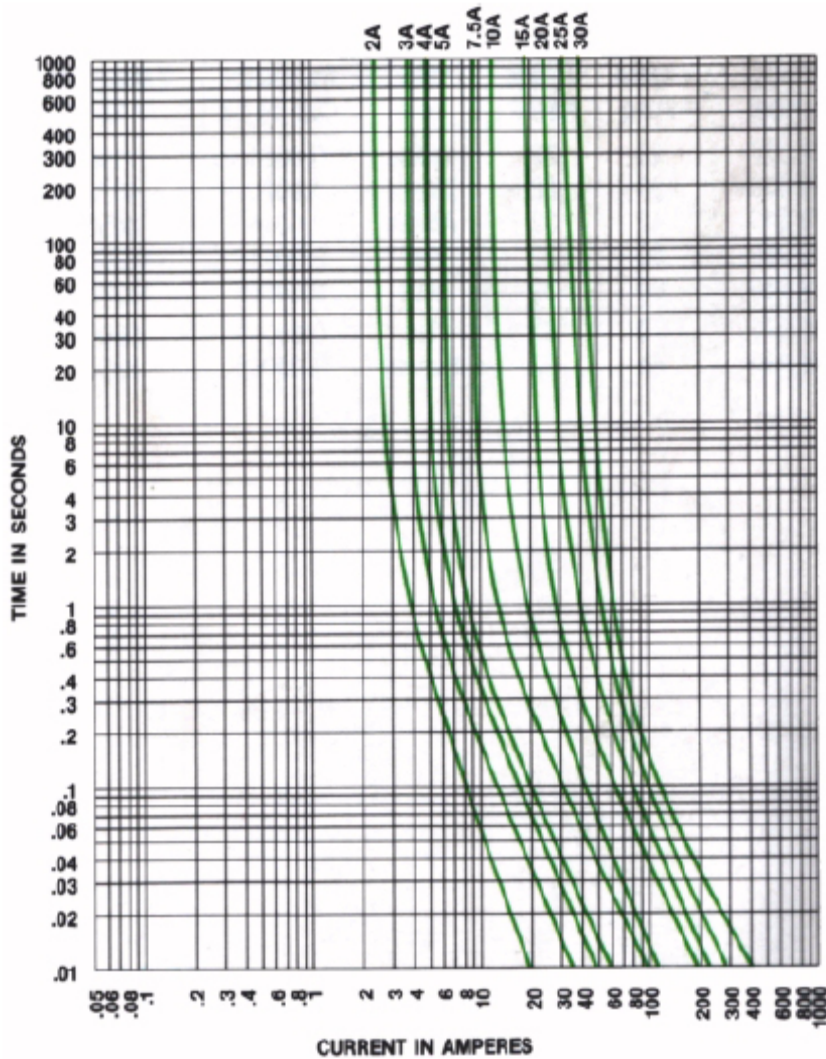

<p><b>Warning:</b></p> 	<p>-Operation beyond the specified maximum ratings or improper use may result in damage and possible electrical arcing and/or flame.</p> <p>-Avoid contact of device with chemical solvent. Prolonged contact will damage the device performance.</p>
--	---